

# Measurement – 1.26

Divide these shapes into rectangles to find the total AREA covered.

Ex.

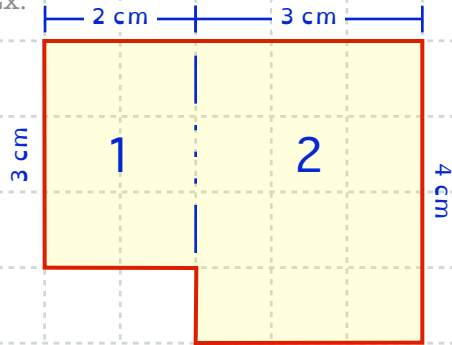

$$\begin{aligned} \text{AREA} &= \text{LENGTH} \times \text{WIDTH} \\ &= (3 \text{ cm} \times 2 \text{ cm}) + (4 \text{ cm} \times 3 \text{ cm}) \\ &= 6 \text{ cm}^2 + 12 \text{ cm}^2 \\ &= 18 \text{ cm}^2 \end{aligned}$$

1.

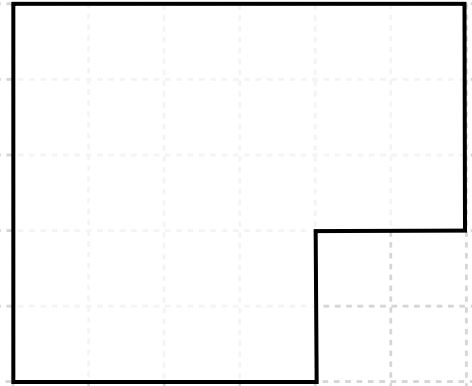

A =

---

---

---

2.

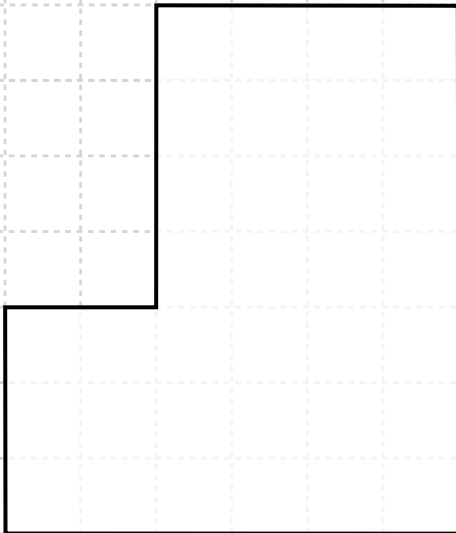

A =

---

---

---

3.

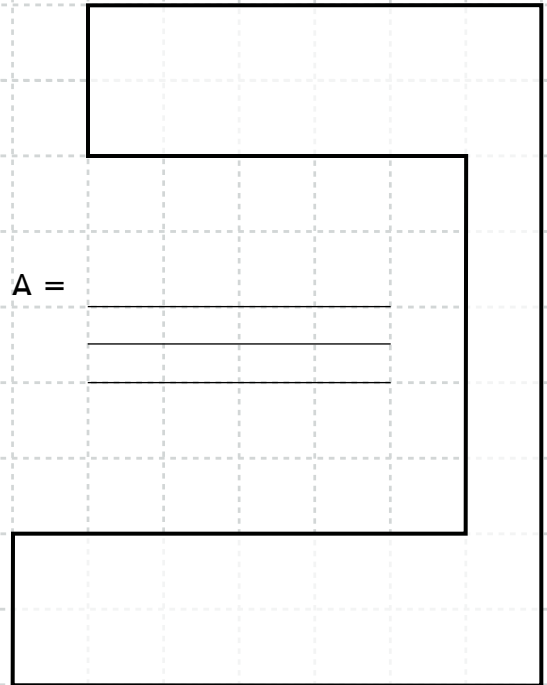

A =

---

---

---